

## Installation kits

for position indicators used on square linear actuators GN 291.1

### SPECIFICATION

#### Coding

- Coding **1**: for mechanical position indicators DD51 (see page 718) / DD52R (see page 721)
- Coding **2**: for electronic position indicators DD52R-E (see page 726) / DD51-E (see page 724)

Adaptor shaft  
Steel  
blackened  
Torque support  
Aluminium  
blank, ground



### INFORMATION

The GN 296 installation kits are needed for mounting a position indicator on linear units. The installation kits comprise an adapter shaft and a torque support including attachment screws.  
Order mechanical position indicators DD52R (see page 721) / DD51 (see page 718) / DD50 (see page 716) with a counter pitch that corresponds to that of the trapezoidal threaded spindle.  
For position indicators DD52R-E (see page 726) / DD51-E (see page 724), the position indicator pitch is programmed.

### ACCESSORY

- Position indicators and handwheels have to be ordered separately.

### TECHNICAL INFORMATION

- ISO-Fundamental tolerances (see page A21)

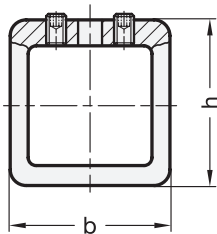

Identification no. 1

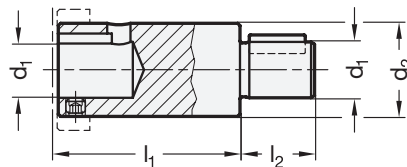

Identification no. 2

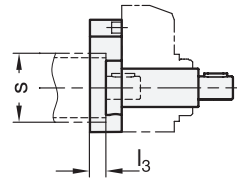
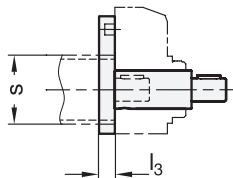

### GN 296

Description	s	d1 f7	d2	b	h	l1	l2	l3	For position indicator	⚖
GN 296-30-8-1	30	8	14	40	43.5	35	15	12	DD51	75
GN 296-40-12-1	40	12	20	50	56.5	39	16	12	DD52R	130
GN 296-50-12-1	50	12	20	60	61.5	39	17	12	DD52R	140
GN 296-30-8-2	30	8	14	40	43.5	42	15	12	DD51	58
GN 296-40-12-2	40	12	20	50	56.5	49	16	12	DD52R	123
GN 296-50-12-2	50	12	20	60	61.5	49	17	12	DD52R	133

